

FROM 26-27 NOVEMBER 2022
DWAS WILL BE HOSTING IN THE NETHERLANDS:



AHBA TRIALS

PROGRAM AND JUDGES:

November 26th 2022, Herding Capability test

Test 1: Judge Bob Lammers

Test 2: Judge Anneke de Jong

November 27th 2022, Herding Trial Arena Dog

Trial 1 : Judge Bob Lammers

Trial 2 : Judge Anneke de Jong

For all the AHBA rules go to www.ahba-herding.org

All Dutch COVID 19 rules apply!!! Please check the latest rules before driving

Please check our website and facebook regularly for updates!
www.dwas.nl /  DWAS Australian Shepherd Club at Facebook

TRIAL INFORMATION

Handlers meeting	starts at 9.00 AM
Coursedirector	Jos van der Meer jos_van_der_meer@hotmail.com
Trial secretary	Lenie Henrion Verpoorten admio@admio.nl
Judges	Bob Lammers & Anneke de Jong
Location	JJRanch Schoterlandseweg 42 8412TA Hoornsterzwaag The Netherlands

Herding Specifications:

Ducks: Runer crosses

Sheep: mix Barbados Black Belly rosses/ Drents heideschaap

Limit is 40 runs per judge per day

Replacement fee ducks; euro 20,00

Replacement fee sheep ; euro 250,00

For all the ahba rules go to www.ahba-herding.org



NOVEMBER 26TH 2022, HERDING CAPABILITY TEST

(The Herding Capability Test Program is run on a pass/not pass system and leads to the title "HCT")

Test 1, Sheep, judge Bob Lammers

Test 2, Sheep, judge Anneke de Jong

There will be 3 head of sheep. Test 1 will be done in the squarepen test 2 will be done in the duckarena. Limit to 25 dogs per test.

For all rules concerning this test, please go to www.ahba-herding.org

NOVEMBER 27TH 2022, HERDING TRIAL ARENA DOG

- Trial 1 : Judge Bob Lammers
HTAD course #2, levels I,II,III
4 head of sheep and 4 head of ducks,
- Trial 2 : Judge Anneke de Jong
HTAD course #2, levels I,II,III
4 head of sheep and 4 head of ducks,

ENTRY INFORMATION

- A dog may enter at any level for which it is trained, as long as it is 9 months old or older. For the HCT the dog should be 6 month or older.
- • Any registration number will do, as long as you keep the same number for all AHBA trials. When you don't have any registration number, you can apply for a tracking number by using the [AHBA tracking number request form](#) from the AHBA website
- • Costs Pre entry sheep and ducks 20 euro per run
 - Day of (if available) + 5 euro per run.
- Entry date November 1 no entries accepted before November 1.
 - Entries close November 19

(USE THE ENTRYFORM THAT'S IN THIS FLYER)

You can fill this out and email it to
Lenie Henrion: admio@admio.nl

Give the original form (with signature) to Lenie before the test/trial starts!

Please transfer the fee to : Rabonbank, Jubbega.
Tnv DWAS

IBAN : NL30RABO0301 2458 19 BIC : RABONL2U
Or to paypal info@dwass.nl (please pay the charges)

AWARDS

HCT if passed green "Pass – Ribbons"

Qualifying ribbons for qualifying runs. Ribbons for place 1 trough 4, special award for high in trial and high combined.

High Combined is the total score calculating ducks and sheep for HTAD, both qualifying and not.

DIRECTIONS TO THE JJ RANCH

Schoterlandseweg 42 - Hoornsterzwaag

From Arnhem (A12) take A50 to Zwolle. Then A28 towards Groningen / Meppel. Then A32 towards Meppel / Leeuwarden. Exit Wolvega N351 towards Oosterwolde.

First roundabout take left (N353) to Oldeberkoop. Next roundabout take a right towards Gorredijk. (N380). At the curve keep going straight towards Jubbega. After 5 km you come to Hoornsterzwaag.

The JJ Ranch is at nr. 42 on your right.

WHERE TO STAY

Hotels:	- Hotel 'Lunia' - Oldeberkoop
Holiday homes	Easterwood - Makkinga
Camp sites	<ul style="list-style-type: none">- Camping 'De Koppenjan' - Jubbega *- Minicamping 'Singel' - Jubbega- Minicamping 'De oude trambrug' - Donkerbroek- Minibospark Jubbega - Jubbega- Camping 'Wilhelminahoeve' - Elsloo * <p><i>* dogs allowed on the camp site not in the holiday homes</i></p>
Bed & Breakfast	B&B 't Lytse hûske, Gorredijk bblytsehuske@outlook.com

Camping on the JJ-ranch grounds only for DWAS-members and volunteers

GENERAL ENTRY INFORMATION

All AHBA rules apply.

DWAS and JJRanch assume no responsibility for any loss, damage, or injury sustained by an exhibitor, handler, dog, property, child or spectator.

- Draw will be posted prior to start of trial.
- Bitches in season will run in draw order.
- Bitches in season will remain crated or in the car when not competing.
Please consider the other contestants dogs.
 - All dogs must be on leash or crated when not competing.
- Changes and/or substitutions, must be submitted to the trial secretary in writing the evening before the trial.
- Any change requests, including substitutions, must be submitted to the trial secretary in writing the evening before the trial.
- Entry fees will be refunded:
 - When a dog has been certified by a licensed veterinarian as unable to compete due to sickness or injury. Owner will be responsible for all vet fees.
 - When the trial has to be cancelled due to the corona virus
 - When your area is in lockdown
- When you or your family members have cold symptoms or flue or are tested positive for the corona virus
- Run limits and judging assignments are subject to change.
- Selling runs will not be permitted. If the trial is full and you wish to sell a run, the transaction must be handled by the trial secretary, who can ask the coursedirector to handle it. All offers to buy or sell runs must be submitted in writing.

Please clean up after your dogs.

This trial is being held on private property. You understand by your attendance and/or entry that the Show/Trial Committee and Hosts have the right to refuse or excuse any entry or spectator for good cause. Good cause would be violation of the private property owners' rights or violation of the AHBA show rules. For the safety of your dogs and others all dogs must have current vaccinations

This county has a leash law. Dogs are not allowed to be let of leash anywhere.
Please consider the wildlife, farmers fields, and other stock.

General Information: [Mail to DWAS](#)

VETERINARIANS

The vets on call are:

Dierenartsencombinatie Gorredijk	De Klok 22 8401 CM GORREDIJK 0513-46 33 13
Dierenartsencentrum Oosterwolde	Venekoterweg 40 8431 HH Oosterwolde 0516-51 27 42

FOOD AND DRINKS

Coffee, tea and cakes are free for everyone.
If you bring something it will be much appreciated.
Lunch will be available for a small donation to the club to cover the costs.

DATA PROTECTION

Due to the GDPR (General Data Protection Regulation), each DWAS member and each trial participant must agree to the processing of his personal data. This approval is to be granted once and serves to ensure the fulfillment of the objectives of the DWAS.

The completed (pdf with text entry) and signed statement is, if not yet submitted in a previous trial, to be added to the trial entry, see <http://www.dwas.nl/de-club.html>

All Dutch Covid 19 rules apply!

Please keep the social distancing on the property, and wash your hands.

If you are sick, or have symptoms of a cold (or somebody in your household),
stay home!

people who stay at the campsite only use the toilets on the campsite,
people who are only in the yard during the day use the toilets in the yard.

Only contestants and members of their immediate household allowed on the
grounds.
No public.

At no time more than 40 people allowed on the property!

You enter this trial on your own health risk.

DWAS reserves the right to cancel all or part of the activities at all times,
when the government's corona measures are adjusted.

Please check the latest rules before driving

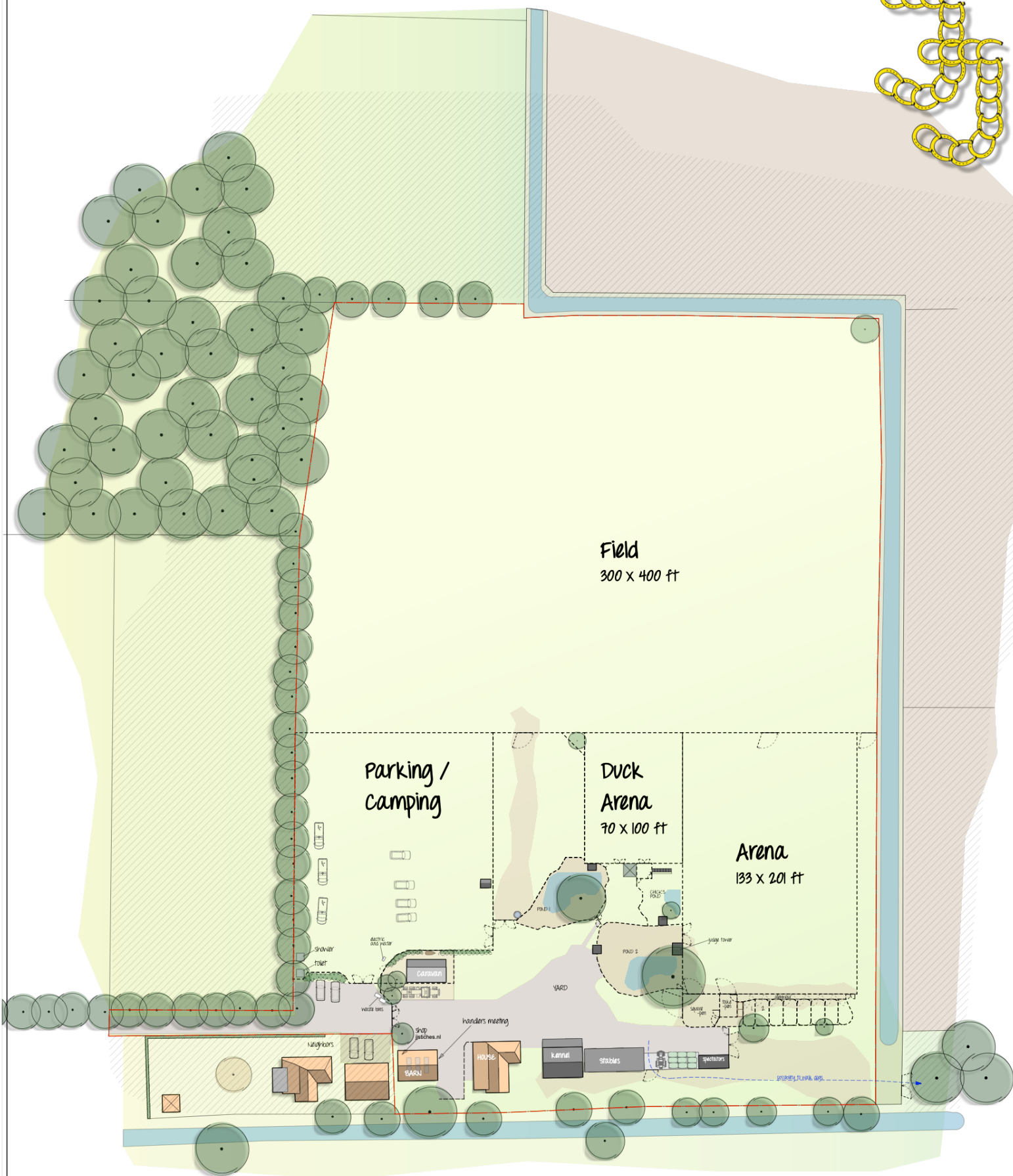
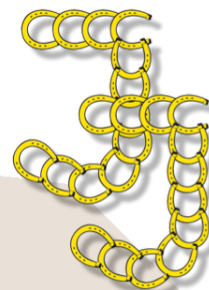

JJ RANCH
HOORNSTERZWAAG
THE NETHERLANDS

COURSE DESCRIPTION - HTAD COURSE # 2 (ARENA TRIAL) DUCKS, SHEEP AND CATTLE

COURSE #2

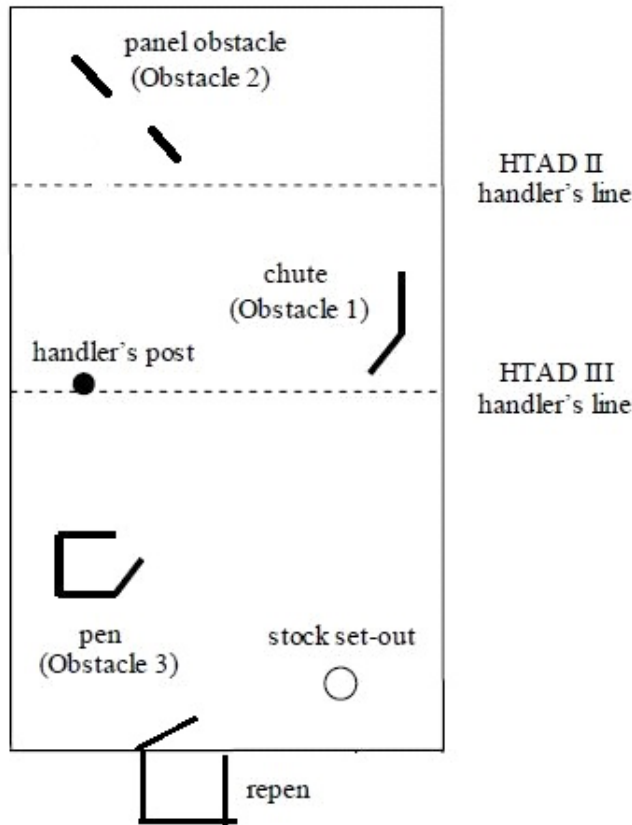

1. Gather: The stock are let out at the repen gate and allowed to settle. In HTAD III, the handler remains at the post while the dog is sent from there to gather the stock. In HTAD II, the handler may leave the dog at the handler's post and move to a point approximately halfway between the post and the stock, then send the dog to gather the stock. In HTAD I, the handler may leave the dog at a point approximately halfway between the post and the stock and move to approximately 15 ft. from the stock, then send the dog to gather the stock. At all three levels the stock are brought to and around the handler's post, on the side between the post and the Y chute. The gather ends when the stock have gone just past the handler's post. The course then proceeds as indicated in the description.

2. Drive: The stock are taken South between the West fence and the freestanding pen, then around the pen to a point just in front of the pen gate. Handlers at all levels may accompany the stock to this point. The stock are then driven to Obstacle 1. HTAD III handlers must remain at the position in front of the pen while the stock are driven to Obstacle 1. HTAD II handlers may accompany the stock and dog to a point halfway to Obstacle 1, then must remain there for the rest of the drive. HTAD I handlers may accompany the stock up to the entrance of Obstacle 1. The drive ends when the stock reach a point 10 ft. in front of Obstacle 1. 3.

3. Obstacle 1 :The stock are taken through the Y chute. HTAD III and II handlers remain at the designated locations until the stock have cleared the Y chute. HTAD I handlers remain at the

entrance of the Y chute until the stock have cleared it. Obstacle 1 ends when the stock have cleared the Y chute.

4. Obstacle 2 Upon the stock exiting the Y chute, the stock are taken through the freestanding panels. HTAD III handlers must remain behind a handler's line that runs the width of the arena even with the handler's post until the stock have cleared the panels. HTAD II handlers must stay on the post side of the handler's line (which runs across the width of the arena, even with the outside edge of the panel that is nearest the center of the arena) until the stock have cleared the panels. HTAD I handlers may accompany the stock up to Obstacle 2, but should not precede the stock through the obstacle. Once the stock have gone through the panels, handlers are free to move. The stock are then turned to the left and taken to the pen; Obstacle 2 ends when the stock have cleared the panels.

5. Obstacle 3 The stock are penned in the freestanding pen. Scoring for the pen ends when the pen gate is closed.

6. Hold The animals are taken to the hold area. The stock is settled and briefly held in place. There is no required position for handler or dog. The judge signals the end of the hold/settle. HTAD I and II handlers then take the stock to the repen. HTAD III handlers proceed with the sort.

7. Sort The sort is done by HTAD III handlers only. The stock is moved to the designated area, which depends on the type of sort being done. The sort on Duck and Cattle will be a gate sort and on Sheep Ribbon-removal. The sort ends when the gate is closed on the sorted animals, or when the ribbon has been removed.

8. Repen The stock are taken to the repen and held a short distance off the gate while it is opened, and then are repenned. When a gate sort has been used, the animals that had been left out in the arena are repenned. The run ends when the repen gate is closed after the last animal has exited the arena.

Time allowed is 10 minutes for level I and II, 12 minutes for level III on ducks and sheep. On cattle for level I and II it is 14 minutes and level III it is 17 minutes.

DWAS AHBA ENTRY FORM

NAME OF CLUB: DWAS

No dog may be entered in two classes on the same course with the same kind of stock under the same judge at any trial.

A dog must be entered in the name of the person who actually owned it at the time entries for the Herding Test or Trial closed

FULL NAME OF DOG _____

BREED _____

SEX _____ MALE / FEMALE

REGISTRATION# _____

DATE OF BIRTH _____

BREEDER _____

SIRE _____

DAM _____

				NOVEMBER 26 2022		NOVEMBER 27 2022	
	LEVEL 1	LEVEL 2	LEVEL 3	TEST 1	TEST 2	TRIAL 1	TRIAL 2
HCT							
SHEEP							
DUCKS							
				TOTAL ENTRY FEES		€	

HANDLER _____

ACTUAL OWNER(S) ADDRESS _____

ZIPCODE AND CITY _____

TELEPHONE # _____

I CERTIFY that I am the actual owner of the dog or that I am the duly authorized agent of the actual owners whose name I have entered above. In consideration of the acceptance of this entry, I (we) agree to abide by the Rules and Regulations of the AHBA in effect at the time of this Herding Test or Trial or both, and further agree to be bound by the agreement printed on the reverse side of this entry form. I(we) certify and represent that the dog entered is not a hazard to persons or their dogs. The entry is submitted on the foregoing representation and agreement.

Signature of Owner &/or agent: _____

Date _____